



FOOD PATHOGENS

RapidChek® CONFIRM™

STEC

Immunomagnetic Separation (IMS) Kit

The RapidChek® CONFIRM™ STEC IMS Kit is designed for the confirmation of the "Big Six" non-O157 and O157 STECs on selective agar in beef samples. The use of this kit increases the accuracy and repeatability and reduces the labor and time required for confirmation.



How the Test Works

The RapidChek® CONFIRM™ STEC IMS confirmation kit uses specific, high-affinity antibodies each attached to separate magnetic particles. Each coated magnetic particle solution is added to a potential positive enrichment and incubated. If any of the STECs are present, it will bind to the magnetic particles via the antibody. A magnet is then used to concentrate the bound magnetic particles and the remaining enrichment is discarded. When the sample is plated to selective agar for confirmation, *E. coli* O26, O45, O103, O111, O121, O145 and O157

are the predominant colonies that form increasing the likelihood of picking that organism from a plate. By reducing the presence of other bacterial species, the accuracy and repeatability of the cultural confirmation is increased and the labor and time decreased.

Validated Applications

The RapidChek® CONFIRM™ STEC IMS Kit is approved by the USDA FSIS in MLG 5B.04 for use in the confirmation of *E. coli* O26, O45, O103, O111, O121, O145 or O157 from potential positive beef samples.

CUSTOMER BENEFITS

- Isolate *E. coli* O26, O45, O103, O111, O121, O145 and O157 present within an enriched sample
- Increases the chances of identifying a "Big Six" non-O157 and O157 STEC from selective agar plates
- Easy to use technology requiring no additional instrumentation
- Validated: Listed in the USDA FSIS MLG 5B.04 for the confirmation of non-O157 STECs

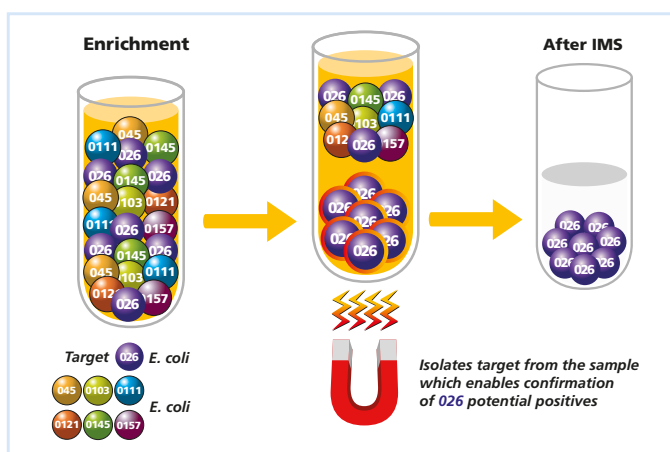
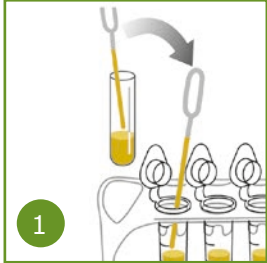

Figure 1. How RapidChek® CONFIRM™ Works: Example O26 Isolation

RapidChek® CONFIRM™ STEC Immunomagnetic Separation (IMS) Kit Pathogen Screening Quick Reference

Read the Package Insert instructions completely before performing any test.



1
Transfer enrichment to sample tube

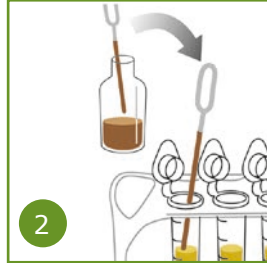

2
Add IMS reagent to tubes and rock them for 15 minutes

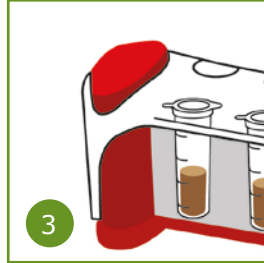

3
Place the sample tubes onto the magnetic rack for 5 minutes



4
Remove unbound material and wash 3 times

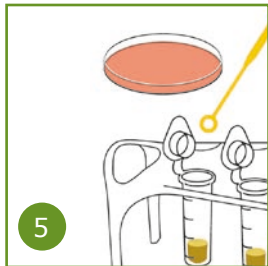

5
Streak out the bound material on selective agar

Ordering Information—RapidChek® CONFIRM™ STEC IMS Kit

Item	Description	Part Number
Confirmation System	100 Confirmation Tests per O-type	10001433
Magnetic Rack	Rack to be used with wash steps of isolation protocol	10001402
Sample Tubes	400 x 2 mL sample tubes to use with magnetic rack	10003687

Also available:

RapidChek® SELECT™ *Salmonella*, RapidChek® SELECT™ *Salmonella* Enteritidis,
RapidChek® *E. coli* O157, RapidChek® *Listeria*, RapidChek® *Listeria* NextDay™