



FOOD PATHOGENS

RapidChek® CONFIRM™

Salmonella Enteritidis Immunomagnetic Separation (IMS) Kit

The RapidChek® CONFIRM™ IMS Kit is designed to be used with the RapidChek® SELECT™ *Salmonella* Enteritidis Test System when confirming the presence of *Salmonella* Enteritidis in high burden samples such as poultry house environmental drag swabs.



How the Test Works

Within an enriched environmental drag swab sample, there are mixed populations of *Salmonella* species typically present, creating a challenging environment for isolation of Group D1, including SE isolates. The use of the RapidChek® CONFIRM™ IMS kit reduces the presence of other non-SE, *Salmonella* species through washing steps and concentrates the Group D1 species. When the sample is struck to selective agar plates for confirmation, Group D1 *Salmonella* are the predominant colonies that form increasing the chances of picking SE if the organism is present within the sample.

By reducing the presence of other non-SE *Salmonella* species, the accuracy and repeatability of the cultural confirmation is increased and the labor and time is decreased.

Validated Applications

The RapidChek® CONFIRM™ *Salmonella* Enteritidis IMS Kit is AOAC approved for use of the confirmation of SE presumptive positive poultry house environmental drag swabs.

CUSTOMER BENEFITS

- Concentrates SE present within an enriched sample
- Increases the chances of identifying SE from selective agar plates
- Easy to use technology requiring no additional instrumentation
- Validated: AOAC-RI and US FDA for environmental drag swabs

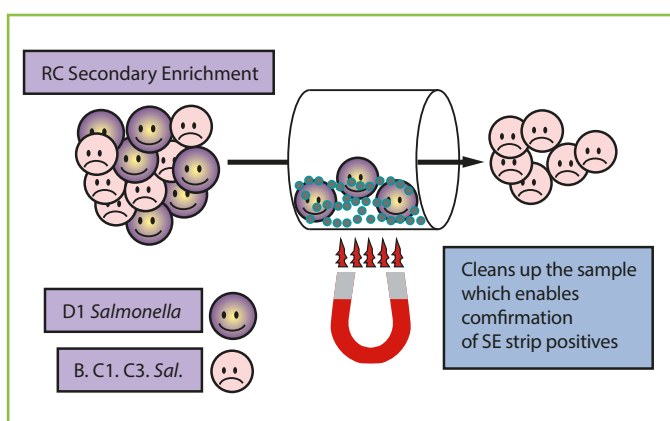
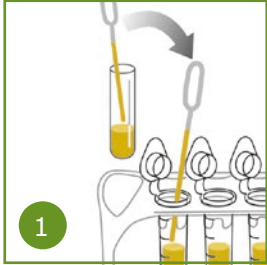

Figure 1. How RapidChek® CONFIRM™ SE works

RapidChek® CONFIRM™ *Salmonella* Enteritidis IMS Kit

Pathogen Screening Quick Reference

Read the Package Insert instructions completely before performing any test.



1
Transfer enrichment to sample tube

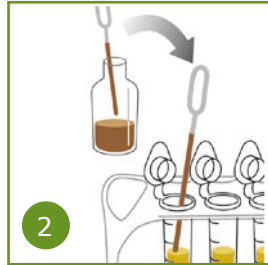

2
Add IMS reagent to tubes and rock them for 15 minutes

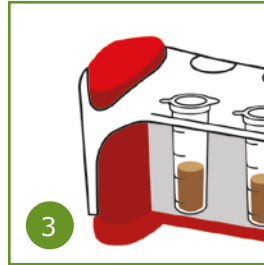

3
Place the sample tubes onto the magnetic rack for 5 minutes

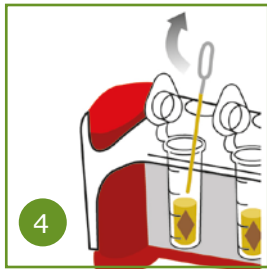

4
Remove unbound material and wash 3 times

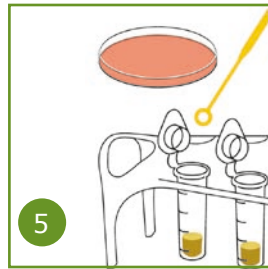

5
Streak out the bound material on selective agar

Ordering Information–RapidChek® CONFIRM™ *Salmonella* Enteritidis IMS Kit

Item	Description	Part Number
Test and Confirmation System	250 Tests for SE Screen 100 Confirmation Tests	10001401
Confirmation System	100 Confirmation Tests	10001400
Magnetic Rack	Rack to be used for wash steps during confirmation protocol	10001402

Also available:

RapidChek® SELECT™ *Salmonella*, RapidChek® SELECT™ *Salmonella* Enteritidis,
RapidChek® *E. coli* O157, RapidChek® *Listeria*, RapidChek® *Listeria* NextDay™, RapidChek® CONFIRM™ non-O157 STEC IMS